

CROWN COLONY

PROPERTIES

presents

359 Half Moon Lane #208 "The Monarch Plan"

OPEN HOUSE
Nov 5 (sun)



One of the most desirable plans in the complex with 2 bdrms, 2 decks, 2 separate vanities, & 2 huge walk-in closets! Freshly painted with new plush carpets throughout, this unit has it all. Enjoy an afternoon out on a spacious private deck with tranquil views of the trees & hillside. Primary Suite has its own private cozy patio and large walk-in closet. The 2nd bdrm is cozy and offers another spacious walk-in closet with 2 entries so can partially serve as a pantry with access from the main hallway. A great unit for a family starting out or if you're just looking to have a separate office/guestroom all at a very affordable price.

- New double pane patio slider doors in both livingroom & bedroom (scheduled to be installed soon)
- New double pane window in 2nd bdrm
- New blinds throughout
- New modern light fixtures
- Laundry and Elevator steps away!



Asking \$579,000

Ulysses C. Maurille, Broker

Your Exclusive On-Site Realtor

650/994-0300



Additional Information:

Built in 1974. Converted to condos in 1984. 817 sq. ft.

Deeded 1-Car parking space, with additional overhead storage cabinet

Laundry room located nearby with 6 full size Washers & Dryers

*HOA Dues \$482.86 month includes water and garbage, common insurance

Monarch Floor Plan

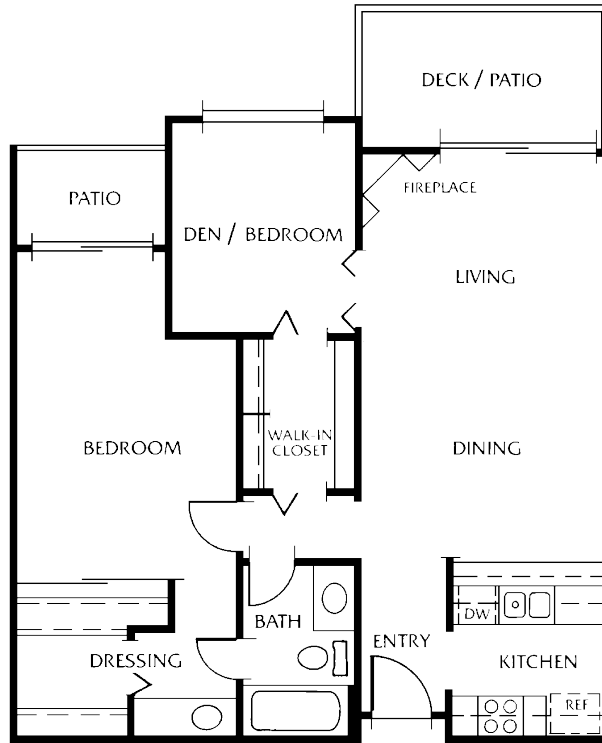

Complex Amenities

Over 23 acres of lush greenery, babbling brooks, and mature trees. Relax by the duck pond & water fountain, in one of two cozy gazebos, or on one of the many well manicured grassy areas and a dog run. A private community with gated entry and 24-hour security. Three story clubhouse with heated swimming pool, hot tub, separate men's and women's sauna & gym, recently refurbished billiards room, quiet study areas, and a cozy library. Enjoy a bright & sunny outdoor pool & hot tub. Over 450 visitor parking spaces for friends & relatives while visiting. Immediate access to 280 North & South.

Close to Serramonte Shopping Center & Gellert Market Place with shopping, restaurants, gas stations and 24-hour convenience store right outside the complex.

